

VWR® Steel Casework

01. ENVIRONMENTALLY FRIENDLY
PAINT SYSTEM

02. HEAVY-GAUGE CONSTRUCTION



The VWR[®] contour[™] REDISHIP collection

The VWR Contour REDISHIP Collection is a Kewaunee line of steel laboratory furniture made in the US, featuring smooth, easy-to-maintain surfaces and heavy-gauge, full-frame steel construction engineered to withstand a full ton of pressure.

Other features of the Contour Collection include:

- One-piece rails radiused at sides and rear
- Enclosed toe space with leveling on all corners
- Self-closing drawers reinforced with sound-dampening material and full-extension, side-mounted slides
- Full-length integral pulls for a sleek, easy-to-clean surface
- All doors and drawers are interchangeable to maximize adaptability

THE PAINT SYSTEM

All Kewaunee steel furniture is protected with an environmentally friendly, electrostatically applied powder coat finish. The laboratory grade formulation meets all SEFA-8 chemical requirements, ensuring that your casework will stand up to heavy-duty laboratory operations. A wide selection of colors is available to create a pleasing, comfortable laboratory.



REDISHIP – ready when you are!

VWR REDISHIP provides you many laboratory furniture items in a matter of days, so whether you need to add some new shelving, quickly replace old lab chairs, or renovate your lab at a moment's notice, we can help. From casework and fume hoods to carts, chairs, and shelving, VWR REDISHIP is ready when you are!

Featured products inside are available through VWR REDISHIP with the exception of those marked (*), which are not available through VWR REDISHIP. All items are subject to availability at time of order. Large quantity orders may require longer lead times. Most REDISHIP items ship within 72 hours of order (based on immediate credit approval).

VWR® Contour™ Style cabinet construction

The Contour style of laboratory furniture features smooth, easy-to-maintain surfaces. The full-width extruded furniture door and drawer pull becomes an integral element of each assembly and accommodates the Kewaunee labeling system. The heavy-gauge, full-frame steel construction has been specially engineered to withstand a full ton of pressure.

All Contour casework is manufactured of prime grade, cold rolled, US Standard sheet steel with no ragged edges.

Cabinet features

- A.** Flush-face construction – all doors and drawers are 3/4" thick with a full-width integral pull.
- B.** Radiused edges on doors and drawers – eliminates sharp corners.
- C.** One-piece drawer body – radiused bottom for easy cleaning.
- D.** Self-closing drawer – can be locked open for loading and unloading. Sound-dampening drawer head for quiet operation. Ball-bearing rollers with nylon tires in drawer-slide channels provide additional load-bearing capability.
- E.** Channel-formed back – constructed for maximum strength. Back is removable on cupboard units for access to pipe space.
- F.** Heavy-gauge hinges – five-knuckle, institutional-type stainless steel hinges that are corrosion resistant to most acids and solvents.
- G.** Positive latch doors – the doors are equipped with an exclusive positive latching mechanism, ensuring that the doors will self-close within the last few inches and prevent rebounding.
- H.** Rubber door bumpers and nylon roller catches – for safe, quiet closing operation.
- I.** Leveling bolt access – provides access for minor adjustments. Cabinet base features a die-formed gusset with a 3" long leveling bolt.
- J.** One-piece case bottom and front rail – bottom rounded at sides and rear for easy cleaning
- K.** Completely enclosed toe space – prevents dirt and bacteria from collecting in inaccessible areas, helping avoid contamination in the lab.



Drawer and cupboard size coding

Steel Drawer Size Codes

Drawer Letter	"Units" High *	Height *	Front to Back Length
C	9	2 ³ / ₈	18
E	12	4 ⁷ / ₁₆	18
F	15	5 ⁷ / ₈	18
G	16	6 ¹⁵ / ₁₆	18
K	24	10 ³ / ₈	18
L	24	11 ¹ / ₂	18
S	3	Pull Out Shelf	Pull Out Shelf

*Interior drawer dimensions.

Steel Drawer Width I.D. (side-to-side)

Base Cabinet Length, in.	Number of Drawers Across		
	1	2	3
18	14 ³ / ₈	—	—
24	20 ³ / ₈	8 ³ / ₈	—
30	26 ³ / ₈	11 ³ / ₈	—
36	32 ³ / ₈	14 ³ / ₈	8 ³ / ₈
42	38 ³ / ₈	17 ³ / ₈	—
48	44 ³ / ₈	20 ³ / ₈	12 ³ / ₈

Steel Door Opening Clearance Width I.D. (side-to-side)

Base Cabinet Length, in.	Number of Cupboards Across		
	1	2	3
18	15 ¹ / ₂	—	—
24	21 ¹ / ₂	9 ¹ / ₂	—
30	27 ¹ / ₂	12 ¹ / ₂	—
36	33 ¹ / ₂	15 ¹ / ₂	9 ¹ / ₂
42	39 ¹ / ₂	18 ¹ / ₂	—
48	45 ¹ / ₂	21 ¹ / ₂	13 ¹ / ₂

Steel Cupboard Size Codes

Door Letter	"Units" High *	Top to Bottom Height, in.*	Front to Back Depth, in.*
AA	30	13 ³ / ₁₆	20 ¹ / ₂
CC	36	16 ⁷ / ₁₆	20 ¹ / ₂
EE	45	20 ¹³ / ₁₆	20 ¹ / ₂
FF	48	22 ³ / ₁₆	20 ¹ / ₂
GG	50	23 ¹ / ₄	20 ¹ / ₂
JJ	54	25 ¹ / ₁₆	20 ¹ / ₂
HH	60	28	20 ¹ / ₂

*Interior cupboard dimensions.

Base cabinets are designed on a "unit" system to allow maximum flexibility in the selection of drawer and/or cupboard door sizes.

Standing height cabinets (35" high) have an opening 60 units high. Sitting height cabinets (29" high) have an opening 48 units high. ADA height cabinets (32" high) have an opening 54 units high. This means that any combination of drawer and cupboard door heights equaling 60, 54 or 48 units can be used in a base cabinet.

Mobile standing height cabinets (33" high) have an opening 56 units high. Mobile sitting height cabinets (26¹/₄" high) have an opening 42 units high.

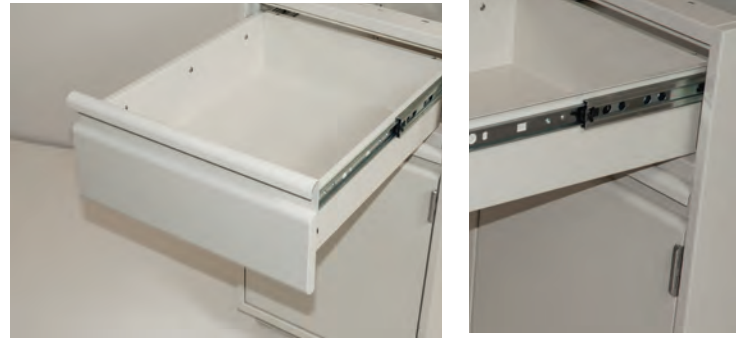

VWR® CONTOUR™ SUSPENDED CABINETS

All suspended height cabinets are 19" or 25" high, 22" deep and 18" wide. Cabinets are designed to hang beneath table frames. Cabinets are phosphate-coated with a baked, chemical-resistant, powder-coat finish. **Color:** light neutral.

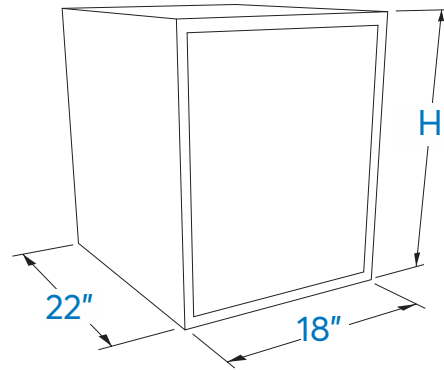

19" DRAWER CABINETS



Three drawer w/ Pull Board

18" W CFD-5002-B



One drawer w/ Pull Board
one file drawer w/ hangers

18" W CFD-5852-B



Swings Right

18" W CFC-5032-A

Swings Left

18" W CFC-5032-L

25" DRAWER CABINETS



Three Drawer

18" W CFD-4002-A

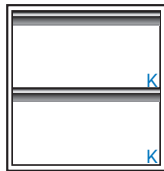

Two file drawers with hangers

18" W CFD-4812-A

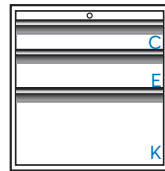

Three drawer w/ Pull Board
one file drawer w/ hangers

18" W CFD-4852-B

25" CUPBOARD CABINETS

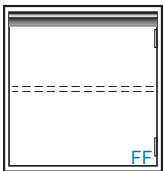

Swings Right

18" W CFC-4032-A

Swing Left

18" W CFC-4032-L

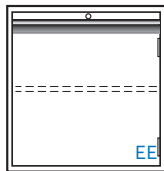

Swings Right w/ Pull Board

18" W CFC-4032-B

Swings Left w/ Pull Board

18" W CFC-4032-BL

25" CUPBOARD AND DRAWER CABINETS

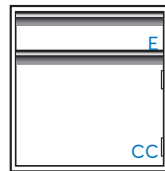

Swings Right

18" W CFE-4402-A

Swings Left

18" W CFE-4402-L

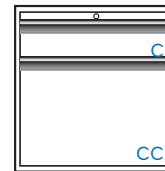

Swings Right w/ Pull Board

18" W CFE-4402-B

Swings Left w/ Pull Board

18" W CFE-4402-BL

VWR® CONTOUR™ SITTING HEIGHT BASE CABINETS

All sitting height cabinets are 29" high and 22" deep. A 1" thick work surface creates an overall height of 30". All cupboard cabinets are supplied with one full-width adjustable shelf. Cabinets are phosphate-coated with a baked, chemical-resistant, powder-coat finish. **Color:** light neutral.

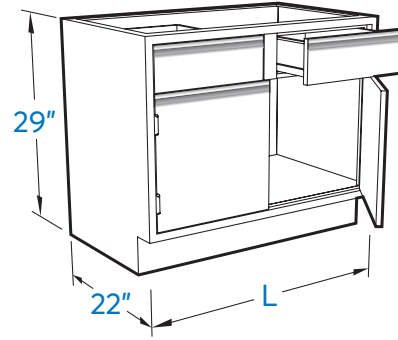

CUPBOARD CABINETS

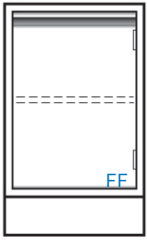

Swings Right	
18" L	CFC-1032-A
24" L	CFC-1034-A
Swings Left	
18" L	CFC-1032-L
24" L	CFC-1034-L

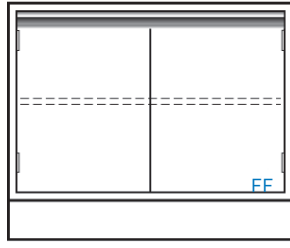

36" L, Double Door	CFC-1036-A
48" L, Double Door	CFC-1038-A

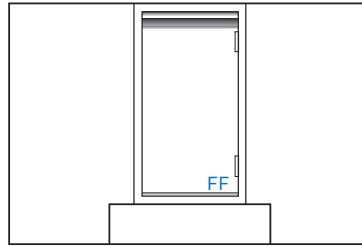

Corner Cabinet	CFG-1149-A
----------------	------------

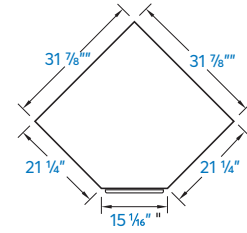

Corner cabinet dimensions

DRAWER CABINETS

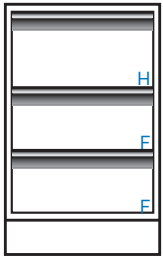

Pull-out shelf	
18" L	CFD-1262-A

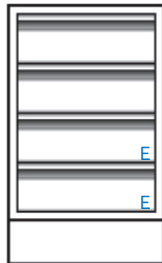

18" L	CFD-1302-A
24" L	CFD-1304-A

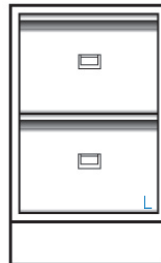

Two file drawers with hangers	
18" L	CFD-1812-A

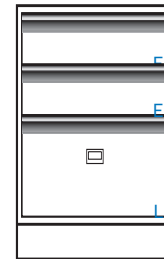

Pull-out shelf, 1 cardfile drawer, 1 file drawer with hangers	
18" L	CFD-1842-A

CUPBOARD AND DRAWER CABINETS

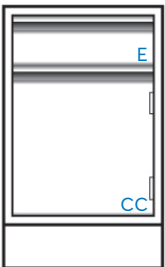

18" L	CFE-1402-A
24" L	CFE-1404-A

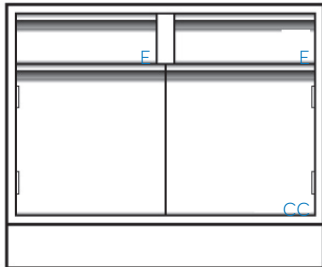

36" L	CFE-1416-A
48" L	CFE-1418-A

Note: For drawer and cupboard size coding and dimensional information, see page 4.

VWR® CONTOUR™ ADA HEIGHT BASE CABINETS

All ADA height cabinets are 32" high and 22" deep. A 1" thick work surface creates an overall height of 33". All cupboard cabinets are supplied with one full-width adjustable shelf. Cabinets are phosphate-coated with a baked, chemical-resistant, powder-coat finish. **Color:** light neutral.

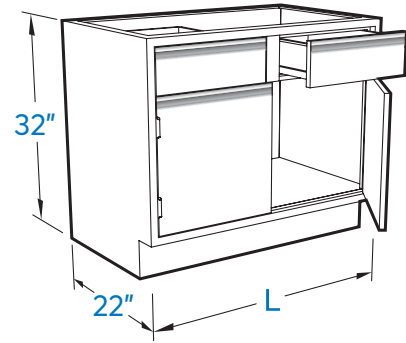

CUPBOARD AND DRAWER CABINETS

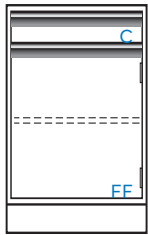

Swings Right	
18" L	CFE-3402-A
Swings Left	
18" L	CFE-3402-L

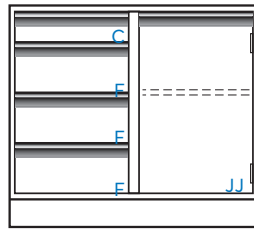

Swings Right	
36" L	CFE-3456-A
Swings Left	
36" L	CFE-3456-L

DRAWER CABINETS

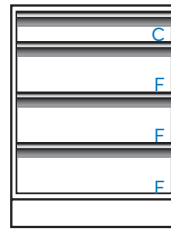

18" L	CFD-3302-A
24" L	CFD-3304-A

FUME HOOD BASE CABINETS

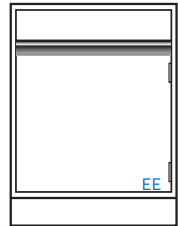

Swings Right	
24" L	CFG-3084-A
Swings Left	
24" L	CFG-3084-L

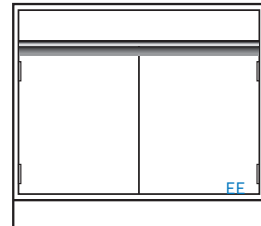

30" L	CFG-3085-A
36" L	CFG-3086-A*
48" L	CFG-3088-A*

ACID STORAGE BASE CABINET

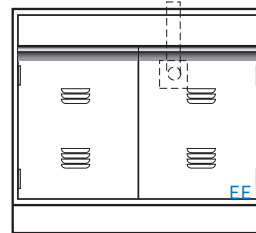

30" L	CFG-3805-A
36" L	CFG-3806-A
48" L	CFG-3808-A

Acid Storage Fume Hood Base Cabinets are specifically designed for the storage of corrosive chemicals. These cabinets are lined with a molded one-piece linear low density polyethylene tub with coved corners and a 1" lip with 1/8" sheet polyethylene. Doors are latched using a nylon roller catch. Each cabinet is furnished with a PVC vent pipe for venting to the fume hood above. (Requires a 2" hole in the hood work-surface.)

Swings Right	
24" L	CFG-3804-A*
Swings Left	
24" L	CFG-3804-L

WHEELCHAIR-ACCESSIBLE BASE CABINETS

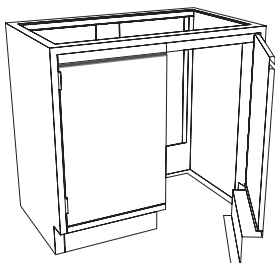

The Wheelchair Accessible Base Cabinet with Doors is designed to be used as a sink unit, but may be used anywhere wheelchair accessibility is needed. The cabinet is constructed without a bottom, and with the toe-space rails attached to the doors so it will match adjacent cabinets when the doors are closed. The cabinet incorporates a 2 3/4" top rail to give a minimum of 29 1/4" of clearance from the floor to the bottom of the rail.

36" L	CFG-3036-A
42" L	CFG-3037-A
48" L	CFG-3038-A

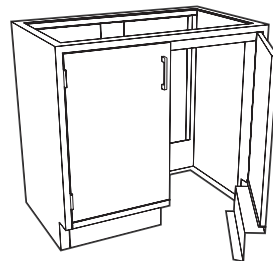

The Wheelchair Accessible Base Cabinet without Doors is designed to be used as a sink unit, but may be used anywhere wheelchair accessibility is needed. The cabinet is constructed without a bottom, and without doors for easy accessibility. The cabinet incorporates a 4 1/2" top rail to give a minimum of 27 1/2" clearance from the floor to the bottom of the rail and a removable sloping knee space panel to enclose piping and drain lines.

36" L	CFG-3076-A*
42" L	CFG-3077-A
48" L	CFG-3078-A*

Note: For drawer and cupboard size coding and dimensional information, see page 4.

*Not available through VWR REDISHIP.

VWR® CONTOUR™ STANDING HEIGHT BASE CABINETS

All standing height cabinets are 35" high and 22" deep. A 1" thick work surface creates an overall height of 36". All cupboard cabinets have one full-width adjustable shelf. Cabinets are phosphate-coated with a baked, chemical-resistant, synthetic powder-coat finish. **Color:** light neutral.

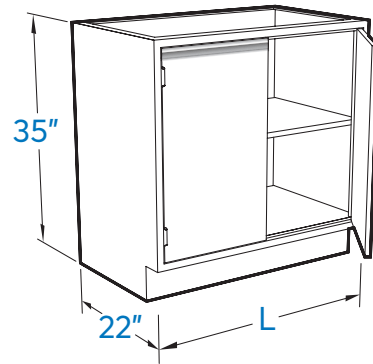

OPEN STORAGE

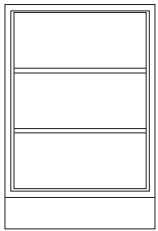

Two adjustable shelves

18" L	CFB-2002-A
24" L	CFB-2004-A
36" L	CFB-2006-A

CUPBOARD CABINETS

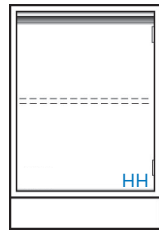

Swings Right

18" L	CFC-2032-A
24" L	CFC-2034-A

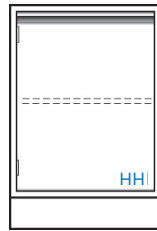

Swings Left

18" L	CFC-2032-L
24" L	CFC-2034-L

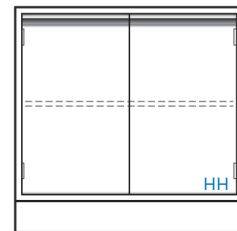

30" L	CFC-2035-A
36" L	CFC-2036-A
42" L	CFC-2037-A
48" L	CFC-2038-A

DRAWER CABINETS

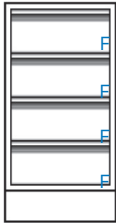

18" L	CFD-2302-A
24" L	CFD-2304-A
36" L	CFD-2306-A
48" L	CFD-2308-A

With Pull Board

24" L	CFD-2304-B
-------	------------

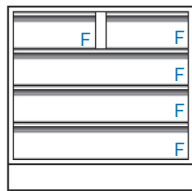

36" L	CFD-2316-A
48" L	CFD-2318-A

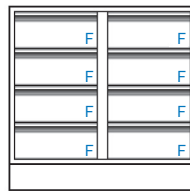

36" L	CFD-2326-A
48" L	CFD-2328-A

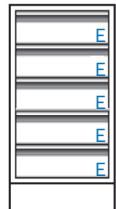

18" L	CFD-2502-A
24" L	CFD-2504-A

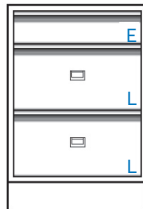

Two file drawers with hangers	
18" L	CFD-2812-A

Note: For drawer and cupboard size coding and dimensional information, see page 4.

CUPBOARD AND DRAWER CABINETS



Swings Right	
18" L	CFE-2402-A
24" L	CFE-2404-A

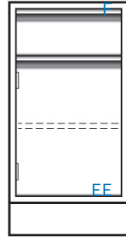

Swings Left	
18" L	CFE-2402-L
24" L	CFE-2404-L

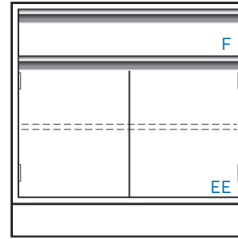

30" L	CFE-2405-A
36" L	CFE-2406-A
42" L	CFE-2407-A
48" L	CFE-2408-A

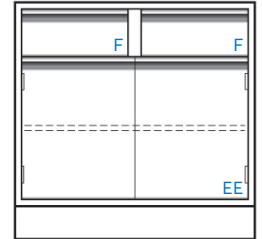

30" L	CFE-2415-A
36" L	CFE-2416-A
42" L	CFE-2417-A
48" L	CFE-2418-A

COMBO CABINETS

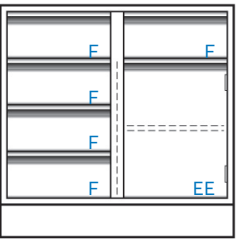

36" L	CFE-2436-A
48" L	CFE-2438-A

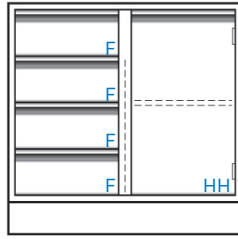

Swings Right	
36" L	CFE-2456-A
48" L	CFE-2458-A
Swings Left	
36" L	CFE-2456-L
48" L	CFE-2458-L

BLIND CORNER CABINETS

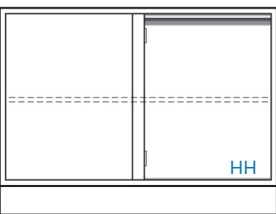

Left side blind, does not open	
48" L	CFG-2128-A

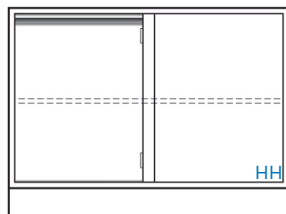

Right side blind, does not open	
48" L	CFG-2138-A

CORNER CABINETS

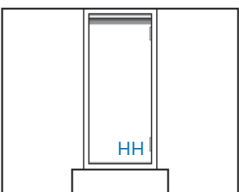

Includes sink support assembly to use, if needed. CFG-2169-A

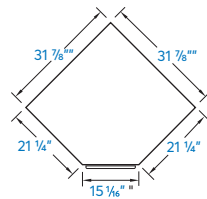

Corner cabinet dimensions

LAZY SUSAN SHELVES

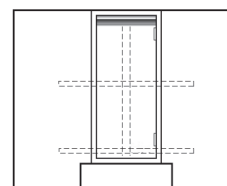

VFG-2149-LS Use only with corner cabinets.

Note: For drawer and cupboard size coding and dimensional information, see page 4.

SINK CABINETS

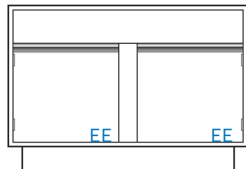
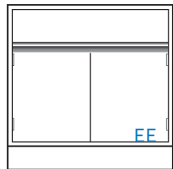

Fits:	part number
24" Cabinet	CFK-MS24-A*
30" Cabinet	CFK-MS30-A
36" Cabinet	CFK-MS36-A
48" Cabinet	CFK-MS48-A*
52" Cabinet	CFK-MS52-A
58" Cabinet	CFK-MS58-A

Swings Right	
24" L	CFG-2004-A
Swings Left	
24" L	CFG-2004-L

30" L	CFG-2005-A
36" L	CFG-2006-A
48" L	CFG-2008-A

52" L	CFG-20452A
58" L	CFG-20458A
60" L	CFG-2009-A

Center bench end furnished with finished back panels that may be removed if not required. Finished back adds 1" to depth, for an overall cabinet depth of 23".

FUME HOOD BASE CABINETS

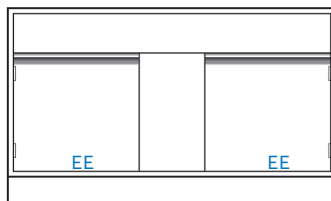
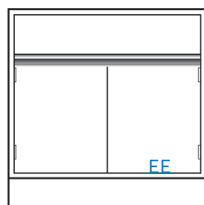

24" L	CFG-2084-A
-------	------------

30" L	CFG-2085-A
36" L	CFG-2086-A
48" L	CFG-2088-A

60" L	CFG-2089-A
-------	------------

PUMP STORAGE CABINETS

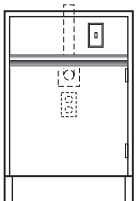

Vacuum Pump Storage Fume Hood Cabinets are designed without a bottom to allow vacuum pumps and other equipment to be rolled in or out of the cabinets. The interior is lined with 1" thick neoprene foam for sound deadening. Each cabinet is furnished with 120 VAC, 20amp, duplex receptacle mounted on the inside cabinet back and a pilot lighted toggle switch mounted in the top front rail. (Wiring is not included). Each cabinet is furnished with a PVC vent pipe for venting to the fume hood above. (Requires a 2" hole in the hood work-surface).

Swings Right	
24" L	CFG-2354-A
Swings Left	
24" L	CFG-2354-L

Pump Cart	
15 x 18 x 6"	CF-C1518-00



ACID STORAGE BASE CABINET

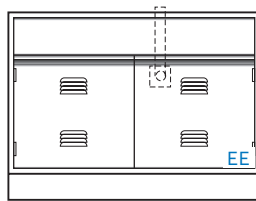

Acid Storage Fume Hood Base Cabinets are specifically designed for the storage of corrosive chemicals. These cabinets are lined with a molded one-piece linear low density polyethylene tub with coved corners and a 1" lip at the bottom front. The cabinet doors are lined with 1/8" sheet polyethylene and are latched using a nylon roller catch. Each cabinet is furnished with a PVC vent pipe for venting to the fume hood above. (Requires a 2" hole in the hood work-surface).

30" L	CFG-2805-A
36" L	CFG-2806-A
48" L	CFG-2808-A

Swings Right	
24" L	CFG-2804-A
Swings Left	
24" L	CFG-2804-L

FUME HOOD SOLVENT STORAGE BASE CABINET

SOLVENT STORAGE BASE CABINET

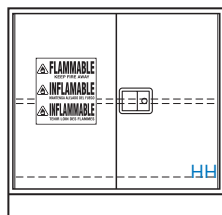
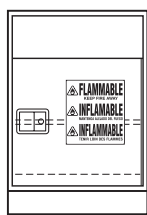
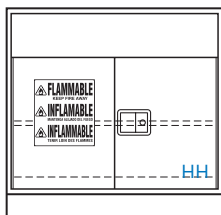

Solvent Storage Cabinets are Factory Mutual approved for the storage of flammable and combustible liquids, meeting UFC, OSHA, and NFPA No. 30-1993 standards. 2" deep, steel, liquid-tight pan covers the entire bottom to contain liquid leaks and spills. The cabinet is provided with a full depth adjustable shelf and two diametrically opposed vents with spark screens in the back of the cabinet for cases where ventilation is required. Steel Solvent Storage cabinets are all 18 gauge steel, double panel construction with self-closing doors, synchronized so that both doors will always full close. The right-hand door is equipped with a three-point latching system that automatically engages the cabinet frame. Each door is equipped with a fusible-link hold-open feature that ensures the doors close should the temperature outside the cabinet exceed 165° F. Cabinets are provided with a grounding screw at the rear.

30" L	CFG-2685-A
36" L	CFG-2686-A
48" L	CFG-2688-A

Swings Right	
24" L	CFG-2684-A
Swings Left	
24" L	CFG-2684-L

36" L	CFG-2636-A
48" L	CFG-2638-A

Note: For drawer and cupboard size coding and dimensional information, see page 4. *Not available through VWR REDISHIP.

VWR® CONTOUR™ APRONS AND LEG ASSEMBLIES

CORNER APRONS

The apron is used to create a knee space for a desk area or to create a free-standing table. Aprons are 4" high.

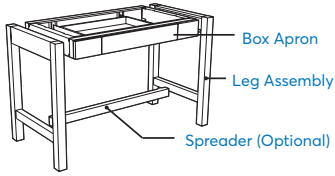

One Drawer Assemblies

22"D x 18"L	CFA012218-A
22"D x 22"L	CFA012222-A
22"D x 24"L	CFA012224-A
22"D x 30"L	CFA012230-A
22"D x 36"L	CFA012236-A
22"D x 42"L	CFA012242-A
22"D x 48"L	CFA012248-A
28"D x 30"L	CFA012830-A
28"D x 42"L	CFA012842-A

Two Drawer Assemblies

22"D x 54"L	CFA022254-A
22"D x 60"L	CFA022260-A
22"D x 66"L	CFA022266-A
22"D x 72"L	CFA022272-A
28"D x 48"L	CFA022848-A
28"D x 54"L	CFA022854-A
28"D x 60"L	CFA022860-A
28"D x 66"L	CFA022866-A
28"D x 72"L	CFA022872-A

CORNER APRONS

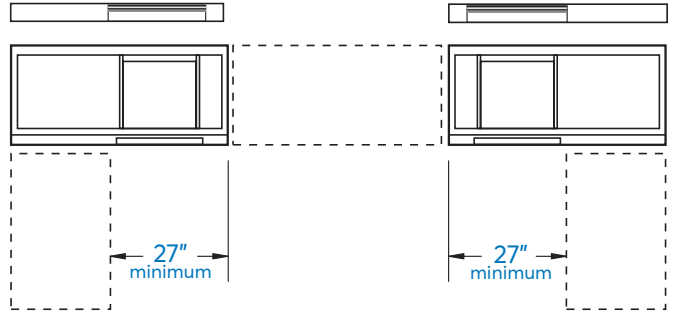
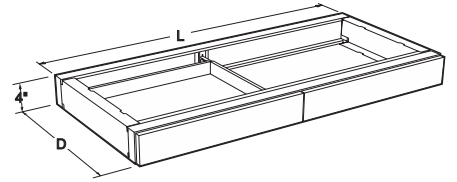

4"H x 22"D x 60"L	1 drawer on left	CFA042260-A
4"H x 22"D x 60"L	1 drawer on right	CFA052260-A

APRON RAILS

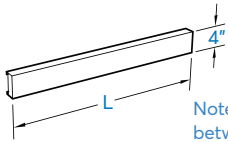

Note: Only to be used between base cabinets.

4"H x 24"L	CFA060424-A
4"H x 30"L	CFA060430-A
4"H x 36"L	CFA060436-A
4"H x 48"L	CFA060448-A
4"H x 60"L	CFA060460-A
4"H x 72"L	CFA060472-A

ADA Apron Rail Rail is 3" high (in lieu of standard 4" height) to accommodate ADA requirements.

3"H x 36"L	CFA060336-A
------------	-------------

Adjustable (To be cut in field)

18-36"L	CFA560436-A
37-48"L	CFA560448-A
49-60"L	CFA560460-A
61-72"L	CFA560472-A

Loose angle supplied to cover cut end.

PEDESTAL LEGS

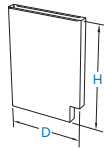

Left Side

29"H x 22"D x 2"W	CFA-2230-L
32"H x 22"D x 2"W	CFA-2233-L
35"H x 22"D x 2"W	CFA-2236-L
30"H x 28"D x 2"W	CFA-2830-L
36"H x 28"D x 2"W	CFA-2836-L

Right Side

30"H x 22"D x 2"W	CFA-2230-R
30"H x 28"D x 2"W	CFA-2830-R
33"H x 22"D x 2"W	CFA-2233-R
36"H x 22"D x 2"W	CFA-2236-R
36"H x 28"D x 2"W	CFA-2836-R

APRON LEG ASSEMBLIES

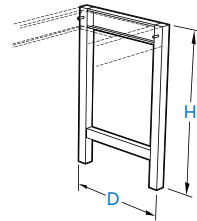

2"W x 22"D x 29"H	CFA-1229-A
2"W x 28"D x 29"H	CFA-1289-A
2"W x 22"D x 35"H	CFA-2229-A
2"W x 28"D x 35"H	CFA-2289-A

ADA "H" Leg Made to comply with ADA requirements.

2"W x 22"D x 32"H	CFA-3229-A
-------------------	------------

TOP MOUNTED APRON LEGS

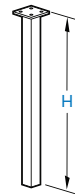

29"H	CFA-1159-A
35"H	CFA-2159-A

2" square leg welded to 4" square steel plate

APRON LEG SPREADERS

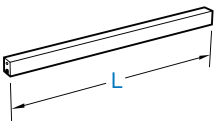

42"L	CFA090242-A
48"L	CFA090248-A
54"L	CFA090254-A
60"L	CFA090260-A
66"L	CFA090266-A
72"L	CFA090272-A

APRON SUPPORT RAILS

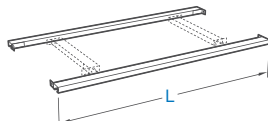

30"L	CFA802230-A
36"L	CFA802236-A
42"L	CFA802242-A
48"L	CFA802248-A

KNEE SPACE FILLER PANELS

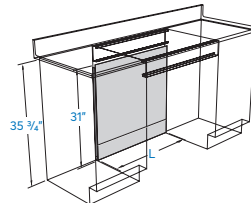

Used to conceal piping in furniture assemblies that include aprons. Two filler angles are included for mounting.

Sitting Height (28")

24" L	CFA102524-A
30" L	CFA102530-A
36" L	CFA102536-A
42" L	CFA102542-A
48" L	CFA102548-A

Standing Height (31")

24" L	CFA103124-A
30" L	CFA103130-A
36" L	CFA103136-A
42" L	CFA103142-A
48" L	CFA103148-A*

*Not available through VWR REDISHIP.

VWR® CONTOUR™ WALL-MOUNTED STORAGE CABINETS

All steel wall cabinets are 30" high and 12¾" deep (except where noted). Lengths as shown. All wall cabinets come with two adjustable shelves. Cabinets are phosphate-coated with a baked, chemical-resistant, powder-coat finish. **Color:** light neutral.

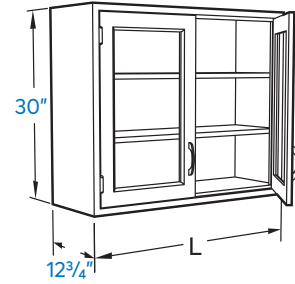

OPEN WALL CABINETS

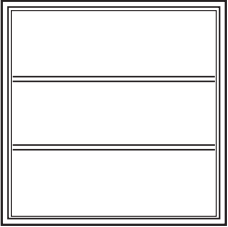

30" High x 12¾" Deep	
36" L	CFW00301336-A*
48" L	CFW00301348-A

36" High x 12¾" Deep	
36" L	CFW00361336-A
48" L	CFW00361348-A

30" High x 16" Deep	
36" L	CFW00301636-A
48" L	CFW00301648-A

36" High x 16" Deep	
36" L	CFW00361636-A
48" L	CFW00361648-A

SLIDING GLAZED DOORS

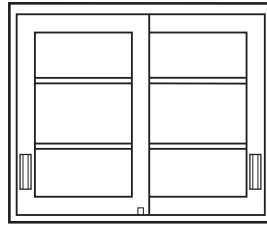

30" High x 12¾" Deep	
30" L	CFW41301330-A
36" L	CFW41301336-A
48" L	CFW41301348-A

30" High x 16" Deep	
30" L	CFW41301630-A
36" L	CFW41301636-A
48" L	CFW41301648-A

SLIDING PANEL DOORS

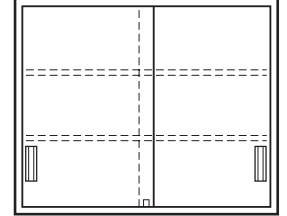

30" High x 12¾" Deep	
36" L	CFW12301336-A
48" L	CFW12301348-A*

30" High x 16" Deep	
36" L	CFW12301636-A*
48" L	CFW12301648-A

SWINGING GLASS DOORS

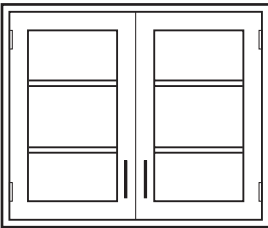

*24" L Cabinets come with one door only, hinged right or left.

30" High x 12¾" Deep		
24" L	Swings Right	CFW50301324-A
24" L	Swings Left	CFW50301324-L
30" L		CFW50301330-A

36" High x 12¾" Deep		
24" L	Swings Right	CFW50361324-A*
24" L	Swings Left	CFW50361324-L
30" L		CFW50361330-A
36" L		CFW50361336-A
48" L		CFW50361348-A

SWINGING PANEL DOORS

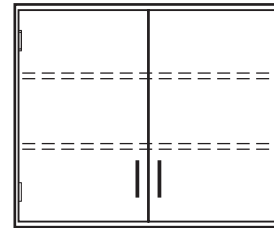

30" High x 12¾" Deep	
30" L	CFW25301330-A
36" L	CFW25301336-A
48" L	CFW25301348-A

36" High x 12¾" Deep	
30" L	CFW25361336-A
36" L	CFW25361336-A
48" L	CFW25361348-A

CORNER CABINET WITH SWINGING GLAZED DOOR

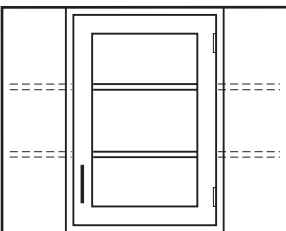

CFW51301320-A

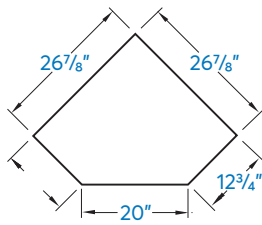

Corner cabinet dimensions

PASS-THRU STORAGE CASES

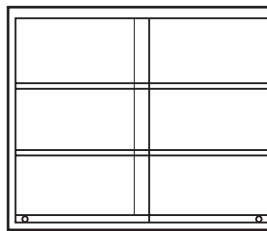

30" High x 12¾" Deep	
36" L	CFW13301336-A
48" L	CFW13301348-A

SLIDING PLATE GLASS DOORS

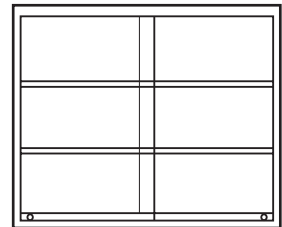

30" High x 12¾" Deep	
36" L	CFW10301336-A
48" L	CFW10301348-A

*Not available through VWR REDISHIP.

VWR® CONTOUR™ FULL HEIGHT STORAGE CABINETS

Standing height steel storage cabinets are 84" high and 12¾", 16", or 22" deep. Length as shown. All standing height storage cabinets have five adjustable shelves. Cabinets are phosphate-coated with a baked, chemical-resistant, powder-coat finish. **Color:** light neutral.

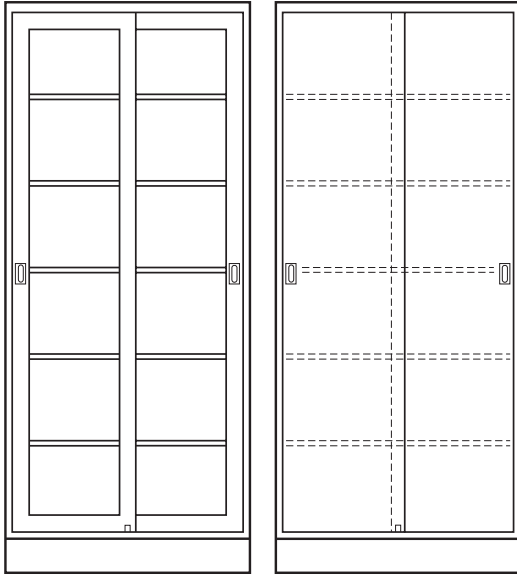

Cabinet Type	Length	Depth	
Open 5-shelf	36"	12 ¾"	CFS00841336-A
Open 5-shelf	48"	12 ¾"	CFS00841348-A*
Open 5-shelf	36"	16"	CFS00841636-A
Open 5-shelf	48"	16"	CFS00841648-A
Open 5-shelf	36"	22"	CFS00842236-A
Open 5-shelf	48"	22"	CFS00842248-A
Glazed Sliding Doors	36"	12 ¾"	CFS41841336-A
Glazed Sliding Doors	48"	12 ¾"	CFS41841348-A
Glazed Sliding Doors	36"	16"	CFS41841636-A
Glazed Sliding Doors	48"	16"	CFS41841648-A
Glazed Sliding Doors	36"	22"	CFS41842236-A
Glazed Sliding Doors	48"	22"	CFS41842248-A*
Panel Sliding Doors	36"	12 ¾"	CFS12841336-A*
Panel Sliding Doors	48"	12 ¾"	CFS12841348-A
Panel Sliding Doors	36"	16"	CFS12841636-A
Panel Sliding Doors	48"	16"	CFS12841648-A
Panel Sliding Doors	36"	22"	CFS12842236-A
Panel Sliding Doors	48"	22"	CFS12842248-A

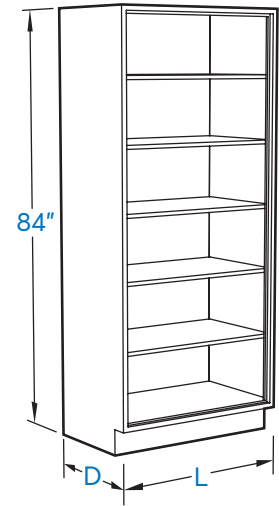

Full height cabinets may present a potential tipping problem. Proper installation requires these cabinets to be anchored to a wall or other cabinets to improve stability and ensure smooth door movement.

VWR® CONTOUR™ BASE CABINET TRIM PARTS

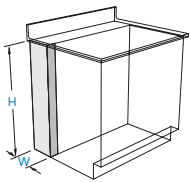

Rear Scribe	
29H x 1"W	CFL-0130-R
29H x 8"W	CFL-0830-R*
32H x 1"W	CFL-0132-R*
32H x 8"W	CFL-0832-R
35 H x 1"W	CFL-0136-R
35 H x 2"W	CFL-0236-R
35 H x 4"W	CFL-0436-R
35 H x 8"W	CFL-0836-R

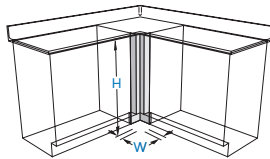

Corner	
35 H x 1" W	CFL-0136-C
35 H x 3" W	CFL-0336-C

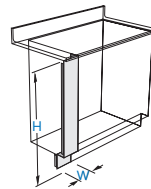

End Scribe	
35 H x 1" W	CFL-0136-E
35 H x 6" W	CFL-0636-E
35 H x 12" W	CFL-1236-E

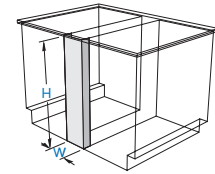

Pipe Chase	
35 H x 2"W	CFL-0236-H
35 H x 8"W	CFL-0836-H
35 H x 14"W	CFL-1436-H
35 H x 16"W	CFL-1636-H
35 H x 20"W	CFL-2036-H

FINISHED BACK PANELS

For backs of base cabinets exposed to view. Add 1" to back of base cabinet. Finish: light neutral.

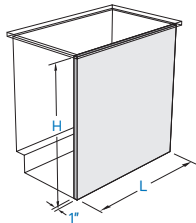

	For 29" Height	For 32" Height	For 35" Height
18" L	CFL-1830-F	CFL-1832-F*	CFL-1836-F
24" L	CFL-2430-F	CFL-2432-F*	CFL-2436-F
30" L	CFL-3030-F	CFL-3032-F*	CFL-3036-F
36" L	CFL-3630-F	CFL-3632-F*	CFL-3636-F
42" L	CFL-4230-F	CFL-4232-F*	CFL-4236-F
48" L	CFL-4830-F	CFL-4832-F*	CFL-4836-F
60" L	CFL-6030-F*	CFL-6032-F	CFL-6036-F

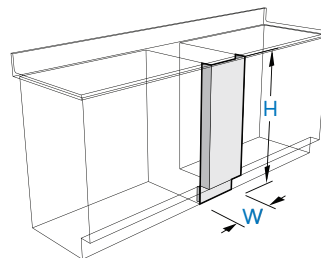

Intermediate Fillers	
35 W x 1" H	CFL-0136-I
35 W x 2" H	CFL-0236-I
35 W x 4" H	CFL-0436-I
35 W x 6" H	CFL-0636-I

Panels are used to close opening between two adjacent base cabinets. Include detached toe space filler.

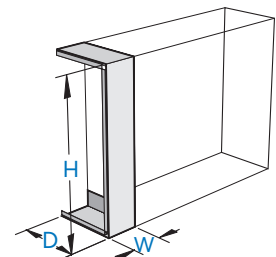

Closes openings between two adjacent wall cabinets.

Wallcase Intermediate Filler	
30 H x 12¾ D x 6" W	CFL-0630-W

*Not available through VWR REDISHIP.

ADJUSTABLE SLIP SCRIBES

Steel Adjustable Slip Scribes are designed the same as standard scribes with the addition of a slip-on angle at the wall edge to dress-up the edge of the scribe. The Steel Adjustable Slip Scribe is designed to be cut to width in the field to more easily fit the space between the wall and the end of the furniture assembly.

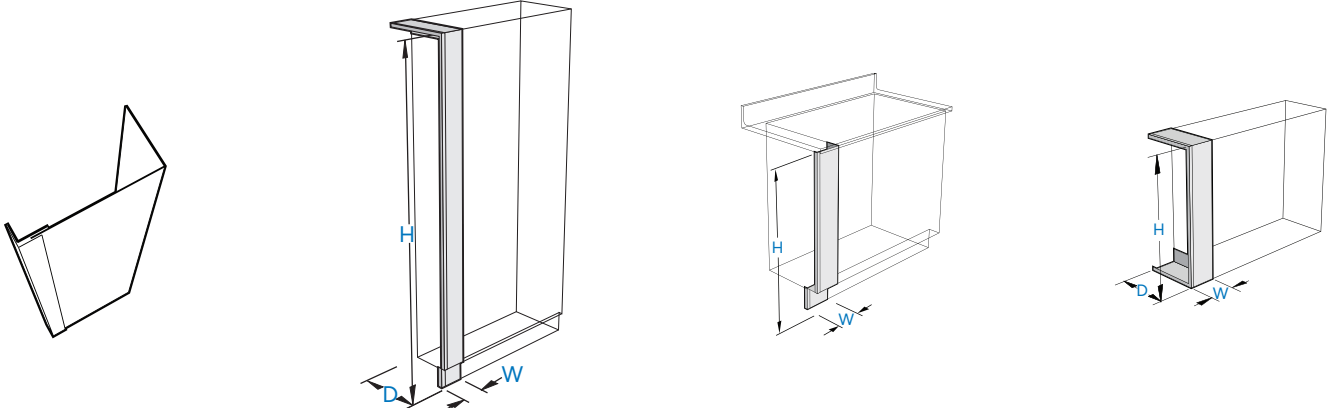

Slip-On Angle	
37" H	CFL-0329-37
84" H	CFL-0329-84*

Full Height Cabinets	
12 3/4 D x 12 W x 84" H	CFL-1384-TA
16 D x 12 W x 84" H	CFL-1684-TA
22 D x 12 W x 84" H	CFL-2284-TA

Base Cabinets	
29 H x 12" W	CFL-3012-BA
32 H x 12" W	CFL-3412-BA
35 H x 12" W	CFL-3612-BA

Wall Cabinets	
30 H x 12 3/4 D x 12" L	CFL-3013-WA
30 H x 16 D x 12" L	CFL-3016-WA
36 H x 12 3/4 D x 12" L	CFL-3613-WA

KEMSTRUT ASSEMBLY

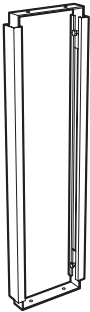

An adjustable height floor mounted support for the rear overhang of fume hood worktops. It can also be used as a worktop and/or a drainline and piping support in the plumbing space of 36 3/4 x 31" wall tables and 36 3/4 x 54" or 36 3/4 x 55" center tables.

27 - 31 H x 8" D	CFK-0011-0A
33 - 37 H x 8" D	CFK-0012-0A
33 - 37 H x 14" D	CFK-0013-0A

LOCK MECHANISMS

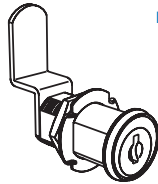

Locks require factory installation.

Door & Drawer Lock Assembly	CFF-5212-04F
Framed Glass Sliding Door Lock	CFF-5212-04FS

METAL WALL ANGLES

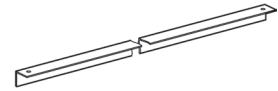

Made of 16-gauge metal, wall angles attach to the wall to support the rear overhang of worktops and wall table service ledges. (Shipped in two 48" lengths)

96L x 1 1/2" x 1 1/2"	VFL-2030-00
-----------------------	-------------

APRON ROLLOUT KEYBOARD SHELF

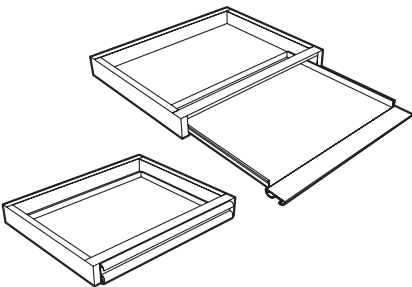

24"W x 3"H x 22"D	CFA01M0219-03
30"W x 3"H x 22"D	CFA01M0220-03
48"W x 3"H x 22"D	CFA01M0221-03

BASE MOLDING

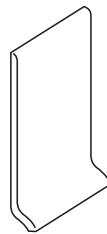

Made of pliable plastic material to match variances in floor surface. Color: black. One 48" length of molding. Specify quantity of lengths required.

4 H x 48" L	VFF-0862-04P
-------------	--------------

BASE MOLDING CORNER CLIP

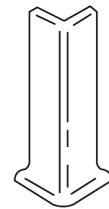

Made of rigid vinyl, the corner clip is shaped to fit over VFF-0862-04 base molding at corners. Color: black.

4 H x 1 1/4" W	VFF-1368-00*
----------------	--------------

*Not available through VWR REDISHIP.

INSTALLATION INSTRUCTIONS

Installation manual for steel casework.
VF-BOOKLET

TOUCH-UP PAINT

High quality air-dry enamel to match Contour casework. Supplied in 8oz. can. CF-1921-61

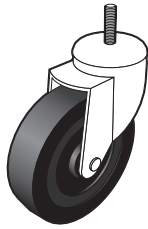

Caster Kit - 4 Casters
CFSP-0045-04

Castors for VWR Contour Tables only.

Screw Package
CFSP-0045-00

Epoxy Cement
1 pt VF-0082-A1
1 qt VF-0082-A2

Kemresin Polish
1 pt VF-0065-A1
1 qt VF-0065-A2*

SECURITY SHELF

Use with base cabinet door locks. Limits access to drawers.

For Half-Width Drawers in 18" or 36" Cabinets	21 W x 16 L x 2" D	CFL-2116-00
For Half-Width Drawers in 24" or 48" Cabinets	21 W x 22 L x 2" D	CFL-2122-00*
For Full-Width Drawers in 18" or 36" Cabinets	21 W x 34 L x 2" D	CFL-2134-00*
For Full-Width Drawers in 24" or 48" Cabinets	21 W x 46 L x 2" D	CFL-2146-00

VERTICAL PIPE ENCLOSURES

Conceal ceiling-to-worksurface service lines. One side is removable for easy access.

Made of cold rolled steel painted to match cabinets to conceal vertical service lines coming down from the ceiling to the worksurface. One side is removable for easy access with no exposed fasteners. Designed to sit on top of curb on worksurface and penetrate drop ceiling.

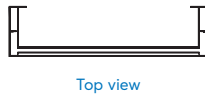
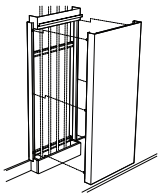

Top view

Wall Mount 90 x 22¼ x 41/8" CFL-0193-65

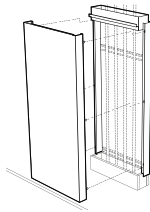

Top view

Center Mount 90 x 22¼ x 51/8" CFL-0193-66

REAGENT RACK ASSEMBLIES

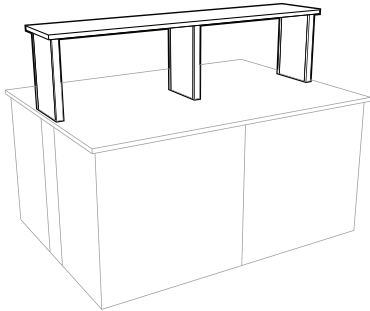

UPRIGHT SUPPORTS

18" High x 12" Deep



CRU-1812-A

12" High x 12" Deep

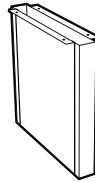

CRU-1212-A

18" High x 10" Deep



CRU-1810-A

12" High x 10" Deep



CRU-1210-A*

ADJUSTABLE WALL SHELVING

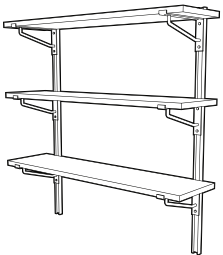

Adjustable Wall Mounted Shelf Brackets are designed to mount to CFF-0170-04. Vertical supports are designed to hold a maximum of three shelves.



Vertical Supports
48" H CFF-0170-04

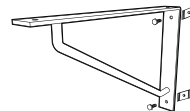

Adjustable Shelf Brackets
12" L CFM-0038-AD
16" L CFM-0044-AD
18" L CFM-0039-AD

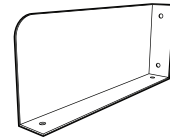

Book End Shelf Brackets
12" L CFM-0060-AD
16" L CFM-0061-AD*
18" L CFM-0062-AD*

*Not available through VWR REDISHIP.

Setting science in motion to create a better world

From breakthrough discovery to agile delivery, we offer an extensive portfolio of mission-critical products, services, and solutions. We are a trusted global partner to customers in the life sciences, advanced technologies, and applied materials industries.



VWR, part of Avantor, provides an integrated, seamless purchasing experience optimized for your success.

Learn how the new Avantor is moving forward at avantorsciences.com



PB19019_NA



VWR.COM

Prices, product, and/or services details are current when published and subject to change without notice. | Certain products or services may be limited by country, federal, state, provincial, or local regulations. | VWR, part of Avantor, makes no claims or warranties concerning sustainable/green products. Any claims concerning sustainable/green products are the sole claims of the manufacturer and not those of VWR International, LLC and/or Avantor, Inc. or affiliates. Offers valid in countries listed above, void where prohibited by law or company policy, while supplies last. | Trademarks are owned by Avantor, Inc. or its affiliates, unless otherwise noted. | Visit vwr.com to view our privacy policy, trademark owners, and additional disclaimers. © 2020 Avantor, Inc. All rights reserved.